

Voicemail Quick Guide

Quick Reference Guide

Follow these quick steps to initialize your Voice Mailbox

1 Activation E-mail

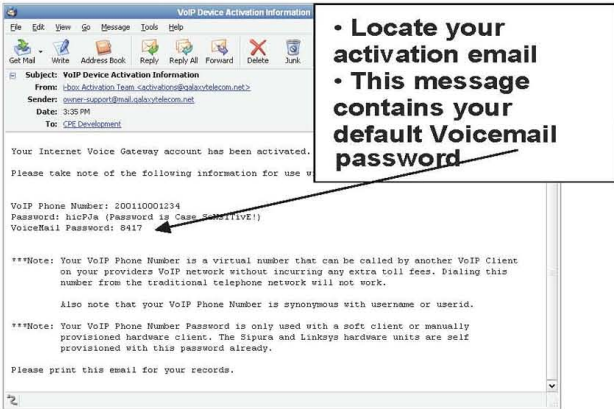

2 Connect to Voicemail

- from your VoIP device dial: ***40**
 - ❖ Enter voicemail **password**
- from a remote phone adapter dial: ***42**
 - ❖ Enter **Voip Phone number**, then enter voicemail **password**
- you may also call your DID followed by: ***** during the greeting
 - ❖ Enter **Voip Phone number**, then enter voicemail **password**

3 Logged in for the first time

1st • Voice prompt will indicate number of new messages...

Voice Mail Reference

